

DHI-ASC4202C-D

Dahua Double Door two-way Access Controller



Technical Specification

System

Main Processor	Embedded Processor
Network Protocol	IPv4;UDP;P2P;IPv6;TCP
OSDP Protocol	Yes
Interoperability	ONVIF PROFILE C
SDK	Yes
API	Yes

Basic

Product Type	Controller
Buzzer	Yes
Casing Material	SGCC galvanized

Function

Verification Method	Card;Password;Fingerprint;Remote;QR Code
Period List	128 groups
Holiday Period	128 groups
Network Update	Yes
First User Unlock	Yes
Remote Verification	Yes
Restricted List/Trusted List	Yes
Peripheral Card Reader	Supports 4-channel RS-485 card readers and 4-channel Wiegand card readers.
Multi-door Interlock	Yes
Multi-user Authentication	Yes
Real-time Monitoring	Yes
Multi-factor Authentication	Yes

- Adopts Linux and comes with a webpage.
- Supports 100,000 users, 100,000 passwords, 100,000 cards, 10,000 fingerprints, and 500,000 access records.
- Supports multiple unlock methods including card, password, fingerprint and QR code. You can also combine them to create your own personal unlock methods.
- Supports RS-485 card reader and Wiegand card reader.
- Offers multiple types of alarms such as duress, tamper, intrusion, unlock timeout, excessive use of illegal card, mains electricity power failure and undervoltage.
- Supports anti-passback, multi-door interlock, multi-person unlock, first-card unlock and remote verification.
- Supplies power to 2 locks (12 V, 1.2 A or lower) and 4 card readers (12 V, 500 mA or lower) at the same time.
- Supports charging and discharging the battery. The battery is sold separately, but a space was reserved for it that is 157 mm × 127 mm × 75 mm (6.18" × 5.00" × 2.95") (L × W × H).
- Features the fire alarm linkage. The device must be connected to the alarm input port and the corresponding linkage must be configured.
- Fire safety control linkage can be accessed through the independent port.
- Supports TCP/IP connection, auto registration, P2P registration and DHCP.
- Compatible with the platforms of SmartPSS Lite, DSS Pro and DMSS.

Web Configuration	Yes
Unidirectional or Bidirectional	Bidirectional

User

User (Card) Type	General user, VIP user, patrol user, guest user, blocklist user, other users, custom user 1 and custom user 2
------------------	---

Capacity

User Capacity	100,000
Fingerprint Capacity	10,000
Card Capacity	100,000
Record Capacity	500,000

Port

RS-485	5 ports. 4 for card readers, and the remaining 1 is for the extension port.
--------	---

DHI-ASC4202C-D

Wiegand	4-channel input
Network Port	1 RJ-45, 10 Mbps/100 Mbps self-adaptive
Alarm Input	7 channels. Channel 1 is for connecting to the fire safety control. Channels 2–3 support alarms for different events. There are 4 statuses for these channels: Normal, alarm, short circuit and open circuit. Channels 4–7 are standard alarm input channels. Expandable to 8 channels when connected to an external alarm module.
Alarm Output	4 channels; expandable to 8 channels when connected to an external alarm module.
Alarm Linkage	Yes
Exit Button	2 channels
Door Status Detection	2 channels
Lock Control	2 channels
Alarm	
Anti-pass Back	Yes
Tamper Alarm	Yes
Duress Alarm	Yes
Door Sensor Timeout	Yes
Intrusion	Yes
Illegal Card Exceeding Threshold	Yes
Duress Fingerprint	Yes
General	
Power Supply	Switching power supply (AC to DC, AC 100–240 V 1.4 A; DC 12 V 6 A)
Power Consumption	≤ 3 W; it might alter if other devices are connected
Product Dimensions	397.6 mm × 262.6 mm × 82.8 mm (15.65" × 10.34" × 3.26") (L × W × H)
Packaging Dimensions	473 mm × 353 mm × 162 mm (18.62" × 13.90" × 6.38") (L × W × H, 1 in inner carton)
Operating Temperature	–30 °C to +60 °C (–22 °F to +140 °F)
Operating Humidity	5%–95% (RH), non-condensing
Operating Environment	Indoor
Gross Weight	4.0 kg (8.82 lb)
Installation	Surface Mount

Ordering Information

Type	Model	Description
Access Controller	DHI-ASC4202C-D	Dahua Double Door two-way Access Controller

Installation

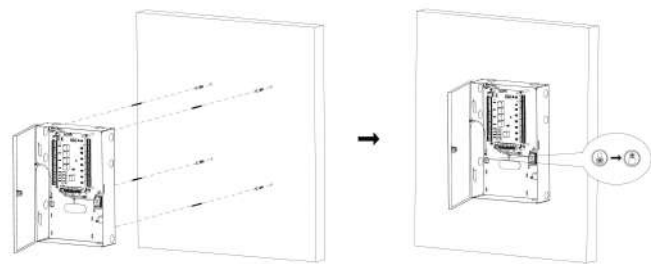

Dimensions (mm[inch])

