

DH-IPC-EBW81230

12MP Panoramic Network IR Fisheye Camera



- 1/1.7" 12Megapixel progressive scan STARVIS™ CMOS.
- H.265/H.264 triple-stream encoding.
- Max 25fps@12M(4000 × 3000).
- Multiple dewarped Mode.
- Day/Night(ICR), 3DNR, AWB, AGC, BLC.
- Smart detection.
- Intelligent Function.
- MaxIR LEDs length 10 m.
- Micro SD memory, IP67, IK10, PoE.



Series Overview

With fisheye lens, Dahua Fisheye series camera can realize 360° surveillance, and it is widely applied in various scenes such as airports, shopping centers, banks and hotels.

Functions

Day/Night

Dahua Day/Night function provides color image when illumination is adequate; when illuminance is inadequate, it switches night mode and provides white and black image. It can guarantee that the network camera can work normally when illuminance changes.

Heat Map

Dahua heat map technology is used to display the crowd density and people appearance probability. Display the crowd status by different colors. Generally, the crowd status is the statistics of people quantity in space and time dimensions.

Protection (IP67, IK10, Wide Voltage)

IP67: The camera passes a series of strict test on dust and soak. It has dust-proof function, and the enclosure can work normally after soaking in 1 m deep water for 30 minutes.

IK10: The enclosure can stand the punch more than 5 times from a 5 kg hammer falling from a height of 40 cm (Impact energy is 20J).

Wide voltage: The camera allows $\pm 30\%$ (for some power supplies) input voltage tolerance (wide voltage range), and it is widely applied to outdoor environment with instable voltage.

Technical Specification

Camera

Image Sensor	1/1.7" CMOS
Max. Resolution	4000 (H) × 3000 (V)
ROM	128 MB
RAM	1 GB
Scanning System	Progressive
Electronic Shutter Speed	Auto/Manual 1/3 s–1/100,000 s
Min. Illumination	0.001 lux/F2.8 (Color, 1/3s, 30 IRE) 0.01 lux/F2.8 (Color, 1/30s, 30 IRE) 0 lux/F2.8 (IR on)
Illumination Distance	Up to 10 m (33 ft)
Illuminator On/Off Control	Auto/Manual
Illuminator Number	3 (IR LED)

Lens

Lens Type	Fixed-focal			
Focal Length	1.98 mm			
Max. Aperture	F2.8			
Field of View	H:180°V:180°			
DORI Distance	Detect	Observe	Recognize	Identify
	42 m (137.80 ft)	17 m (55.77 ft)	8 m (26.25 ft)	4 m (13.12 ft)

Smart Event

IVS	Tripwire, Intrusion
Heat Map	Yes

Video

Video Compression	H.265+; H.265; H.264+; H.264
Video Frame Rate	Main Stream: 4000 × 3000@(1–25 fps)/2880 × 2880@(1–25/30 fps) Sub Stream: 704 × 576@(1–25/30 fps)/704 × 480@(1–25/30 fps) Third Stream: 1280 × 960@(1–25/30 fps) *The values above are the max. frame rates of each stream; for multiple streams, the values will be subjected to the total encoding capacity.
Stream Capability	3 streams
Resolution	12M (4000 × 3000); 8M (2880 × 2880); 6M (2880 × 2160); 3M (2048 × 1536); 1.3M (1280 × 960); D1 (704 × 576/704 × 480); CIF (352 × 288/352 × 240)
Bit Rate Control	CBR/VBR
Video Bit Rate	H.265: 3 kbps–9984 kbps H.264: 8 kbps–16384 kbps
Day/Night	Auto(ICR)/Color/B/W
BLC	Yes
HLC	Yes
WDR	DWDR
White Balance	Auto/Natural/Street Lamp/Outdoor/Manual/Regional Custom

Gain Control	Auto/Manual
Noise Reduction	3D NR
Motion Detection	OFF/ON (4 areas, rectangular)
Region of Interest (RoI)	Off/On (4 Zone)
Smart Illumination	Yes
Defog	Yes
Privacy Masking	4 areas

Audio

Built-in MIC	Yes, built-in Mic
Audio Compression	G.711a; G.711Mu; G.726

Network

Network Port	RJ-45 (10/100/1000 Base-T)
Network Protocol	HTTP; HTTPS; TCP; ARP; RTSP; RTP; UDP; SMTP; FTP; DHCP; DNS; DDNS; PPPOE; IPv4/v6; QoS; UPnP; NTP; Bonjour; 802.1x; Multicast; ICMP; IGMP; SNMP
Interoperability	ONVIF, PSIA, CGI
User/Host	10 Users/20 Users
Storage	NAS; Local PC for instant recording; Mirco SD card 128GB
Browser	IE, Chrome, Firefox, Safari
Management Software	Smart PSS; DSS; Easy4ip
Mobile Client	iOS; Android
Management Software	Smart PSS; DSS; DMSS
Mobile Client	iOS; Android

Certification

Certifications	CE (EN 60950: 2000) UL: UL60950-1 FCC: FCC Part 15 Subpart B
----------------	--

Port

Audio Input	1 channel (RCA port)
Audio Output	1 channel (RCA port)
Alarm Input	2 channels in: wet contact, 5 mA 3–5 VDC
Alarm Output	2 channels out: dry contact, 1,000 mA 30 VDC/500 mA 50 VAC

Power

Power Supply	12 VDC/PoE (802.3af)
Power Consumption	<12W

Environment

Operating Temperature	–30 °C to +60 °C (–22 °F to +140 °F)
Operating Humidity	0%–95% (RH), non-condensing
Storage Temperature	–30 °C to +60 °C (–22 °F to +140 °F)
Protection	IP67; IK10

Structure

Casing Material	Metal
Product Dimensions	Φ149.8 mm × 47.7 mm (Φ5.9" × 1.88")
Net Weight	0.58 kg (1.28 lb)
Gross Weight	1 kg (2.2 lb)

Ordering Information

Type	Model	Description
12MP camera	DH-IPC-EBW81230P	12MP Panoramic Network IR Fisheye Camera, PAL
	DH-IPC-EBW81230N	12MP Panoramic Network IR Fisheye Camera, NTSC
	IPC-EBW81230P	12MP Panoramic Network IR Fisheye Camera, PAL
	IPC-EBW81230N	12MP Panoramic Network IR Fisheye Camera, NTSC
Accessories (Optional)	PFA100	Mount Adapter
	PFB302S	Wall Mount
	PFA152	Pole Mount
	PFA105	Mount Adapter
	PFA110	Mount Adapter
	PFB300C	Ceiling Mount

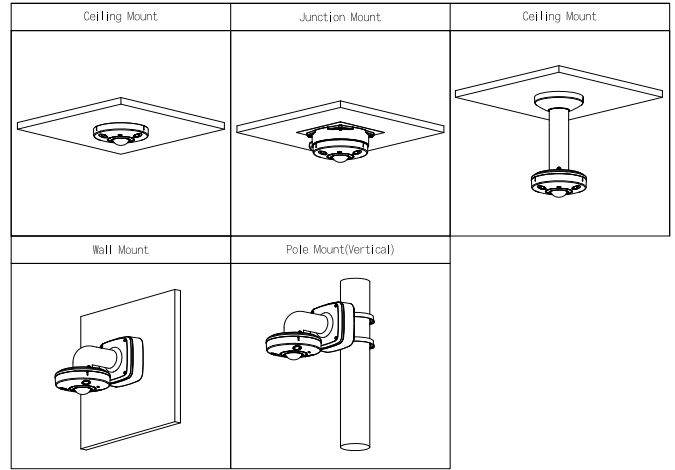

Dimensions (mm[inch])

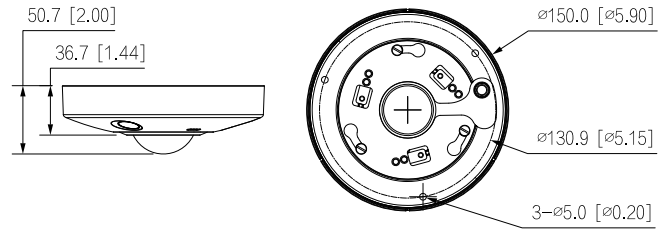

Accessories

Optional:



PFA100
Mount Adapter



PFB302S
Wall Mount



PFA152
Pole Mount



PFA105
Mount Adapter



PFA110
Mount Adapter



PFB300C
Ceiling Mount