

DH-PFA101

Mount Adapter



- Built of aluminum alloy.
- Matched with particular cameras, beautiful and elegant designed.



Series Overview

The Mounting Bracket works with front-end services, supporting installation methods such as wall mount, pole mount, corner mount and in-ceiling mount. Select brackets are designed to suit complex scenes, making them convenient to use in environments with high temperatures, humidity, frequent vibrations, and in locations that are highly corrosive. These highly reliable brackets are easy to install and use.

Scene

Ideal for mounting cameras, and works in temperatures ranging from -40°C to $+60^{\circ}\text{C}$ (-40°F to $+140^{\circ}\text{F}$) and in environments with a relative humidity of less than 90%.

Technical Specification

Structure

| | |
|--------------------|--|
| Casing Material | Aluminum alloy |
| Product Dimensions | $\Phi 159.0\text{ mm} \times 34.6\text{ mm}$ ($\Phi 6.26'' \times 1.36''$) |
| Appearance Color | White |
| Net Weight | 0.23 kg (0.51 lb) |
| Gross Weight | 0.28 kg (0.62 lb) |
| Load Bearing | 3.0 kg (6.61 lb) |
| Installation | Ceiling mount |
| Screw Thread Type | G1 1/2 |
| Applicable Model | Please see "Camera Accessories Selection" |

Packaging Dimensions

177 mm \times 177 mm \times 52 mm (6.97" \times 6.97" \times 2.05")
(L \times W \times H)

Environment

| | |
|-----------------------|--|
| Operating Temperature | -40°C to $+60^{\circ}\text{C}$ (-40°F to $+140^{\circ}\text{F}$) |
| Operating Humidity | <90% (RH) |
| Storage Temperature | -40°C to $+60^{\circ}\text{C}$ (-40°F to $+140^{\circ}\text{F}$) |
| Storage Humidity | 10%–90% (RH) |
| Anti-corrosion Level | Basic Protection |

Ordering Information

| Type | Model | Description |
|--------------|-----------|---------------|
| Camera Mount | DH-PFA101 | Mount Adapter |

Installation

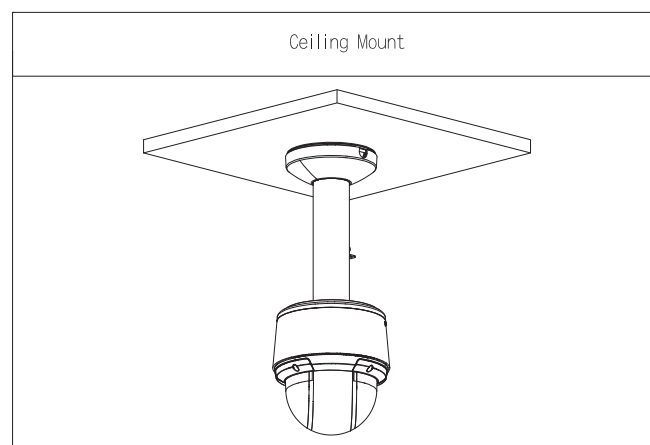

Dimensions (mm[inch])

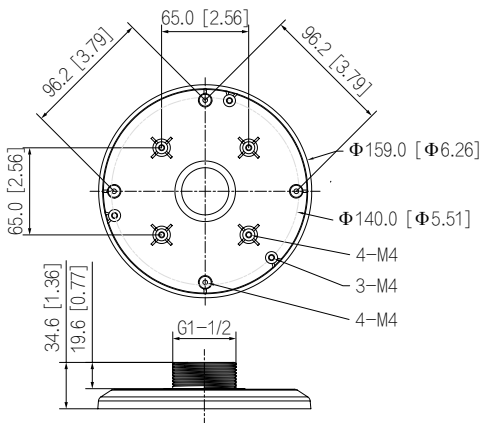

Package Information

- Mount adapter × 1
- M4×10 screw × 4