

DH-PFS3103-1GT1ET-60

3-Port Switch with 2-Port PoE



Features

- Layer-two Unmanaged PoE Switch
- Conforms to IEEE802.3, IEEE802.3u and IEEE802.3X standards
- MAC auto study and aging, MAC address list capacity is 8K
- Conforms to IEEE802.3af and IEEE802.3at power supply standard. Port 2 and 3 support Hi-PoE 60W power supply
- Adopts metal structure
- High protection grade, supports common mode 4KV, differential mode 2KV
- Supports DC 48V-DC 57V power supply and dual power backup
- Supports -30°C~65°C operating temperature

Technical Specification

Model	DH-PFS3103-1GT1ET-60
Ethernet Port	1*RJ45 10/100M (PoE) 1*RJ45 10/100/1000M (PoE) 1*SFP 100/1000M (uplink)
PoE Power Consumption	Port2 and port 3 support Hi-PoE 60W Totals≤60W
PoE Protocol	IEEE802.3af, IEEE802.3at, Hi-PoE
Switching Capacity	6.8Gbps
Packet Forwarding Rate	3.12Mpps
Packet Buffer Memory	1Mb
Application Humidity	10%~90%
Power	DC48-57V
Lightning Protection	Common Mode 4KV Differential Mode 2KV
Working Temperature	-30°C~65°C
Dimension(W×D×H)	105mm x75mm x30mm

Dimensions (mm)

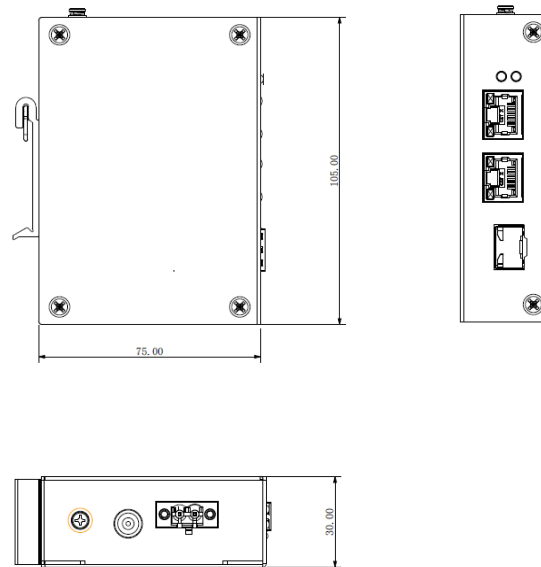

Accessories

Model	
PFT3950	1.25G 850nm,500m,LC, Multi-mode
PFT3960	1.25G 1310/1550nm,20km,LC, Single-mode
PFT3970	1.25G 1550/1310nm,20km,LC, Single-mode